



Horsley Court

Montaigne Close, Westminster, SW1P 4BF

£600 Per Week



1



1



1



D

Floor Plan

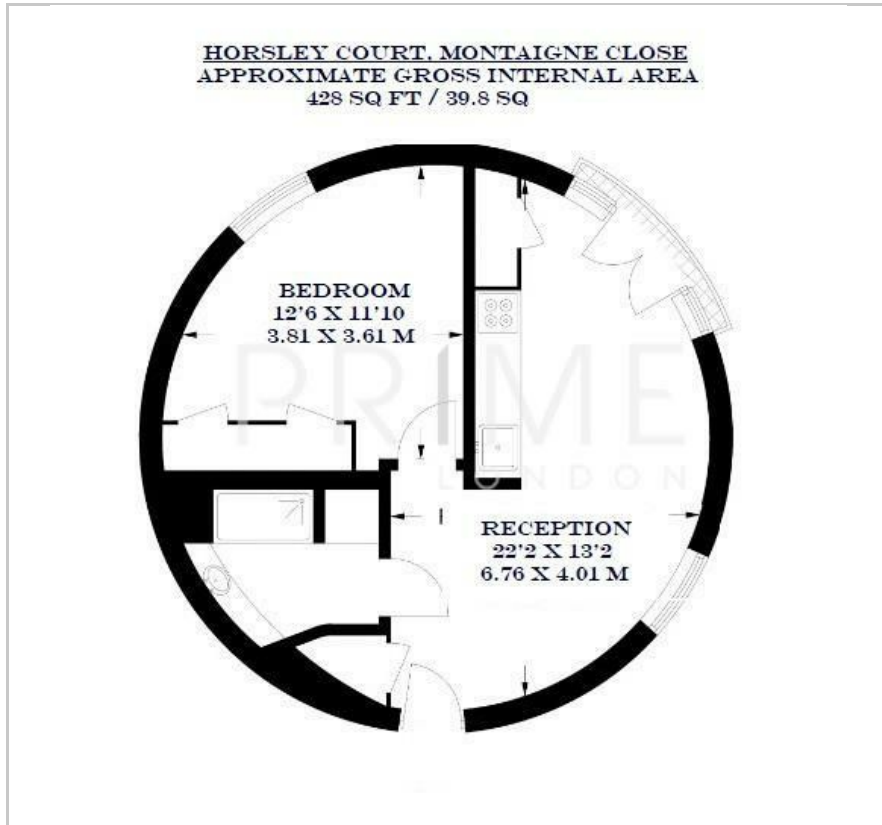

Area Map



Energy Efficiency Graph

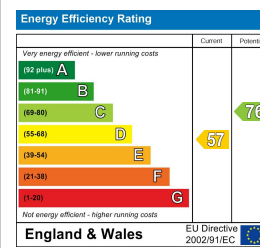

Viewing

By appointment. Contact us on 0207 052 1075 if you wish to arrange a viewing appointment for this property, or require further information.

- Unique one bedroom ▪ Furnished apartment
- Spacious open plan living ▪ On Site Gym room
- Close to London Victoria, ▪ 24 Hour Concierge Pimlico and St James



This fully furnished one bedroom apartment, spanning 428 sq ft (40 sqm) within Horsley Court, is available for lease through Prime London.

This unique apartment, located within an exclusive gated development, comprises an open-plan reception room and kitchen, an ultra-modern bathroom, and a spacious private garden area.

Horsley Court is ideally positioned in the heart of Westminister, just south of St James's Park and Victoria, and north of Pimlico. The property is within easy reach of the numerous amenities, restaurants, and shops of Victoria, Westminister, and St James's. Local parklands, including Green Park and St James's Park, are also easily accessible.

Transport links are excellent, with Pimlico Underground Station (Victoria Line) approximately 0.2 miles away.

Residents of Horsley Court benefit from on-site facilities, including a concierge service and gym.



These particulars, whilst believed to be accurate are set out as a general outline only for guidance and do not constitute any part of an offer or contract. Intending purchasers should not rely on them as statements of representation of fact, but must satisfy themselves by inspection or otherwise as to their accuracy. No person in this firm's employment has the authority to make or give any representation or warranty in respect of the property.